

HOW TO ASSEMBLE THE CLOCK MOVEMENT

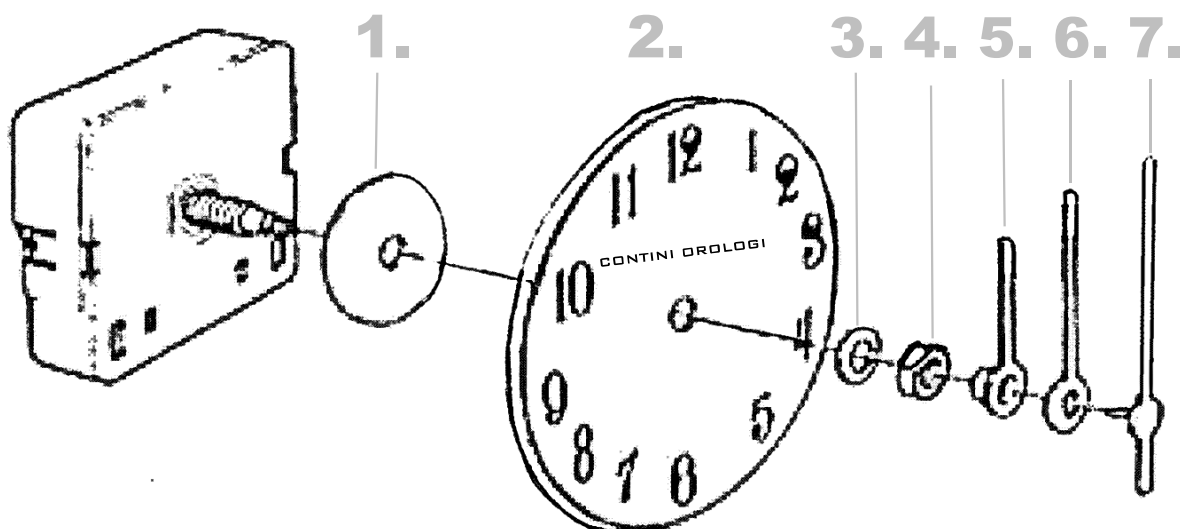

## INSTRUCTIONS

1. Put the rubber ring over the shaft of clock movement.
  2. Sequentially insert the dial of clock.
  3. Insert the washer.
  4. Insert the hexagon nut and screw it. Please put attention to not tighten overly. The clock movement needs to be well fixed to the dial.
  5. Enter the hour clock, fitting it with a light push. Place the hour hand on h 12:00.
  6. After enter the minute hand with the same process.
  7. At last, insert the second hand on the hub of the shaft.
- To verify the good working of clock movement, please turn the second hand until doing a full rotation.

## HOW TO ASSEMBLE THE CLOCK HANDS CORRECTLY

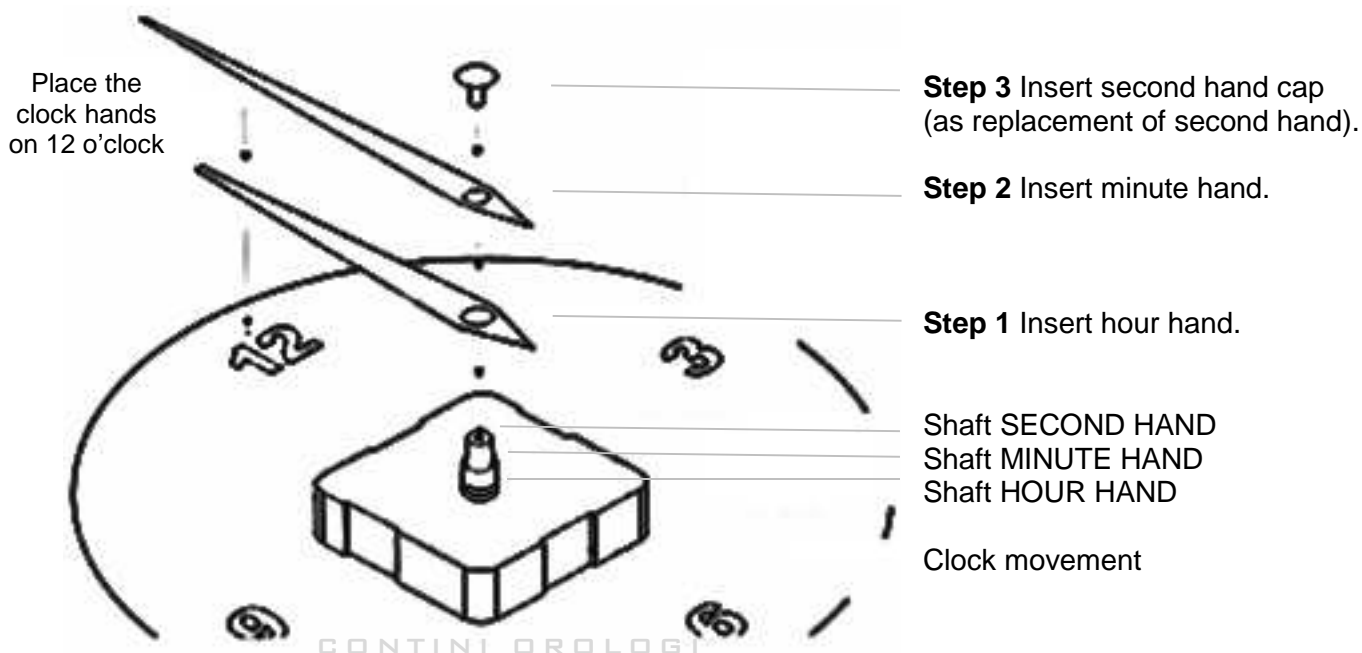

Insert the "AA" battery and your clock will begin to keep time. The time can be set by turning the time-set knob on the back of clock movement.